













GROUND FLOOR
222 JOHNSTON ST
COLLINGWOOD
VIC 3066
SCALE 1:100
@A2

LEGEND

-  EXIT light sign
-  Wall mount fire extinguisher
-  Fire hydrant
-  Fire hose reel
-  Fire hose
-  Toilet
-  Wash basin
-  Sink basin
-  Shower
-  Roller door
-  660 litre waste bin
-  660 litre paper bin
-  660/240 litre recycle bin

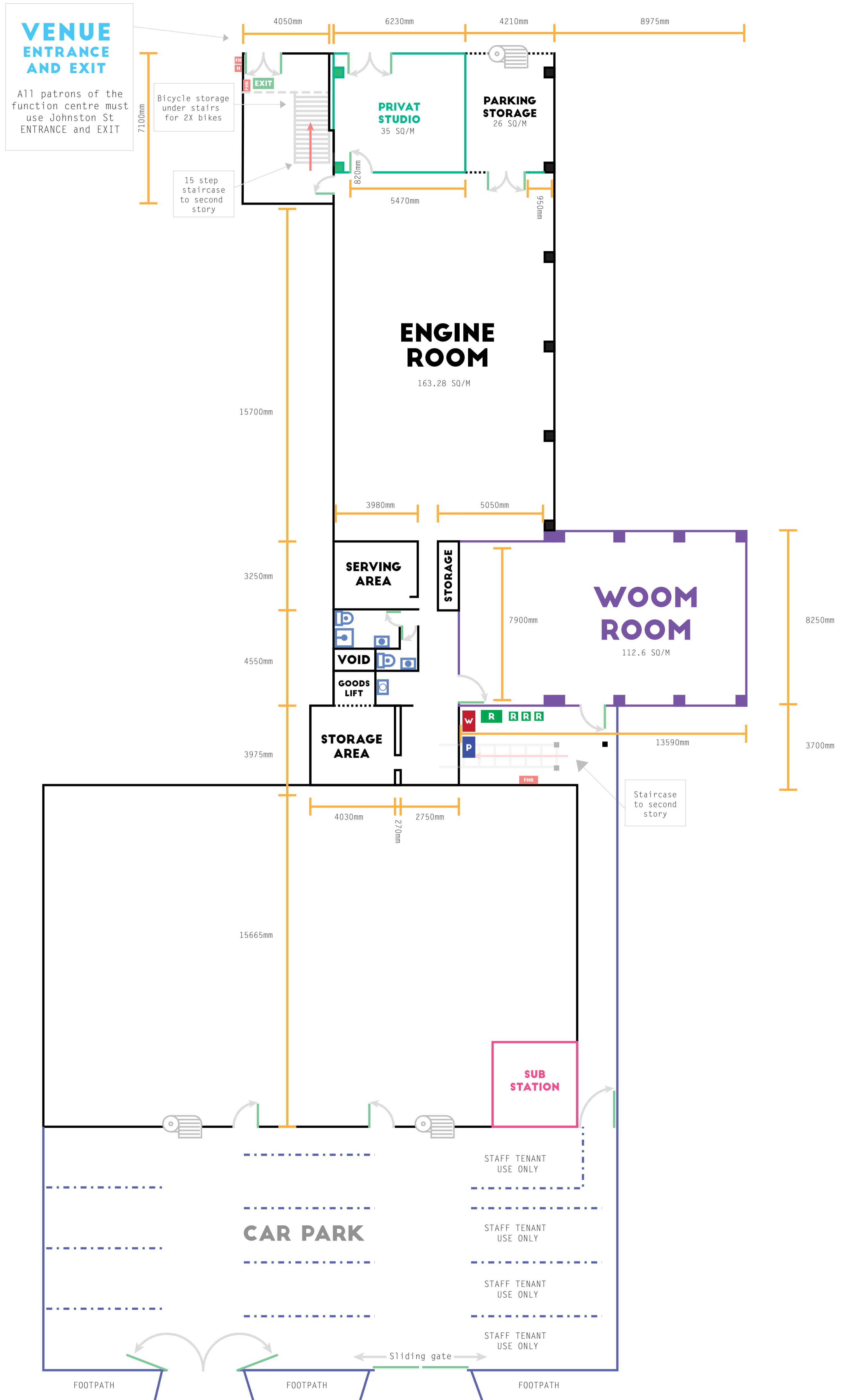

PERMIT NO
PLN14/1218
PLANNING SCHEME:
Yarra
RESPONSIBLE
AUTHORITY:
City of Yarra
ADDRESS OF LAND:
Level 1, 222 Johnston St,
Collingwood, VIC 3066
PREPARED BY:
Michael Gill
SECOND STORY
STUDIOS PTY LTD
P: (03) 8802 5143
info@secondstory.com.au
www.secondstory.com.au

SECOND STORY

Studios

LEVEL 1
222 JOHNSTON ST
COLLINGWOOD
VIC 3066
SCALE 1:100
@A2

LEGEND

- EXIT EXIT light sign
- F/E Wall mount fire extinguisher
- H Fire hydrant
- FHR Fire hose reel
- FH Fire hose
- T Toilet
- WB Wash basin
- SB Sink basin

PERMIT NO

PLN14/1218

PLANNING SCHEME:

Yarra

RESPONSIBLE AUTHORITY:

City of Yarra

ADDRESS OF LAND:

Level 1, 222 Johnston St,
 Collingwood, VIC 3066

PREPARED BY:

Michael Gill

SECOND STORY STUDIOS PTY LTD

P: (03) 8802 5143

info@secondstory.com.au

www.secondstory.com.au

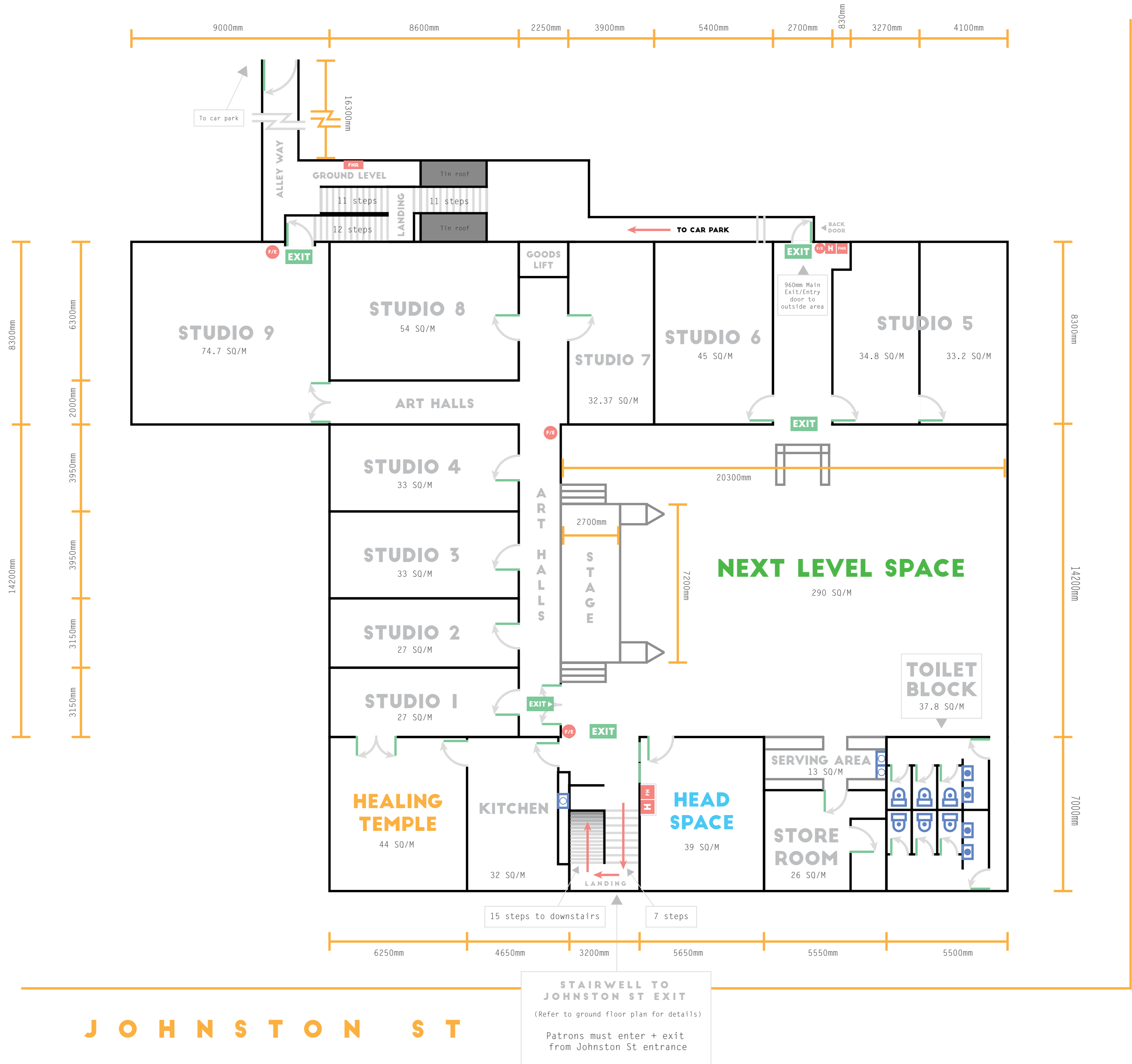

H O P P L E S T