

Castlemaine Town Hall Building Plan

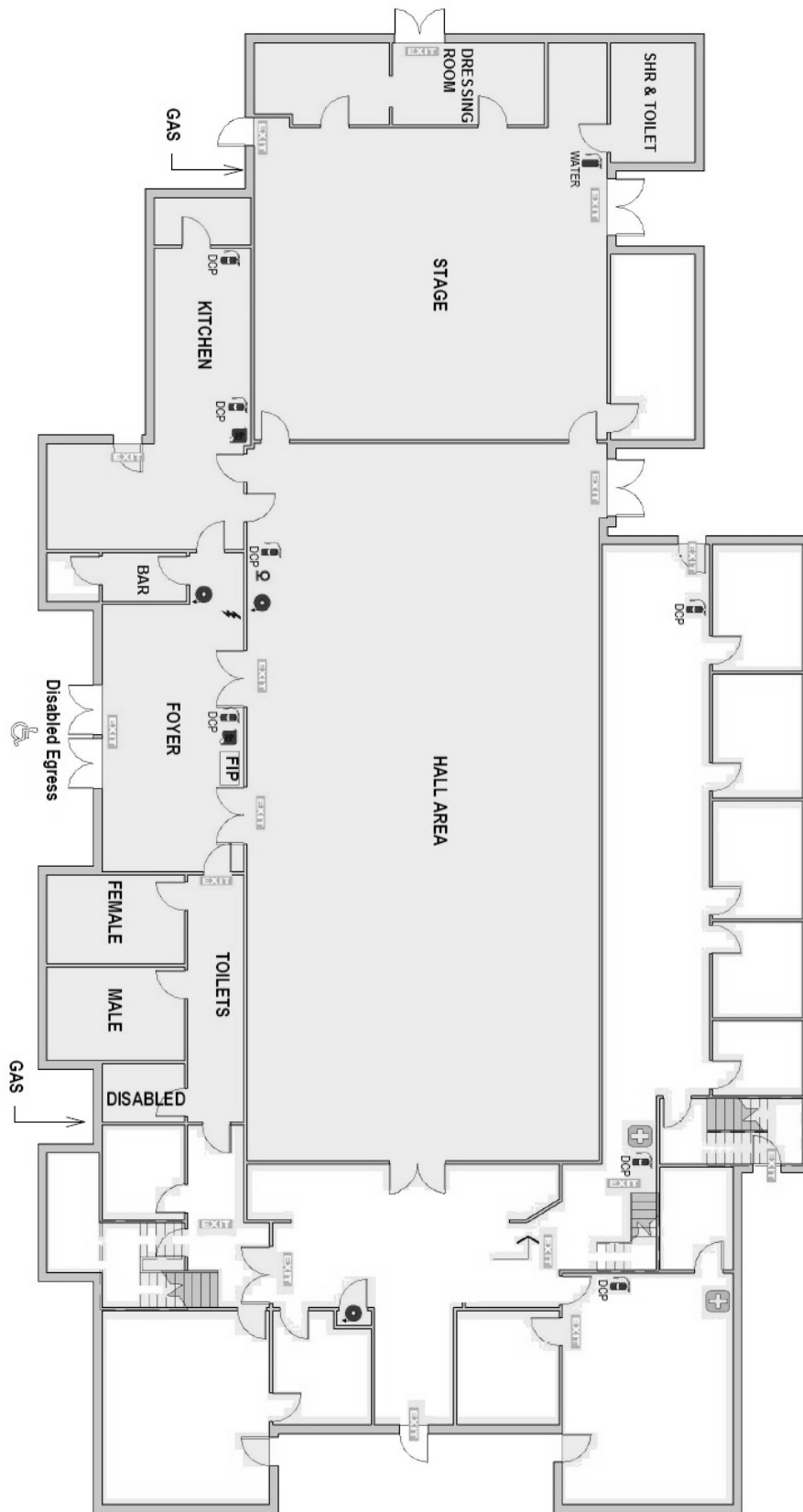

- Civic Centre
- Cnr Lyttleton and Lloyd Sts
- P.O Box 185 Castlemaine VIC 3450
- t (03) 5471 1700
- e info@mountalexander.vic.gov.au
- w www.mountalexander.vic.gov.au

Castlemaine Town Hall Floor Plan

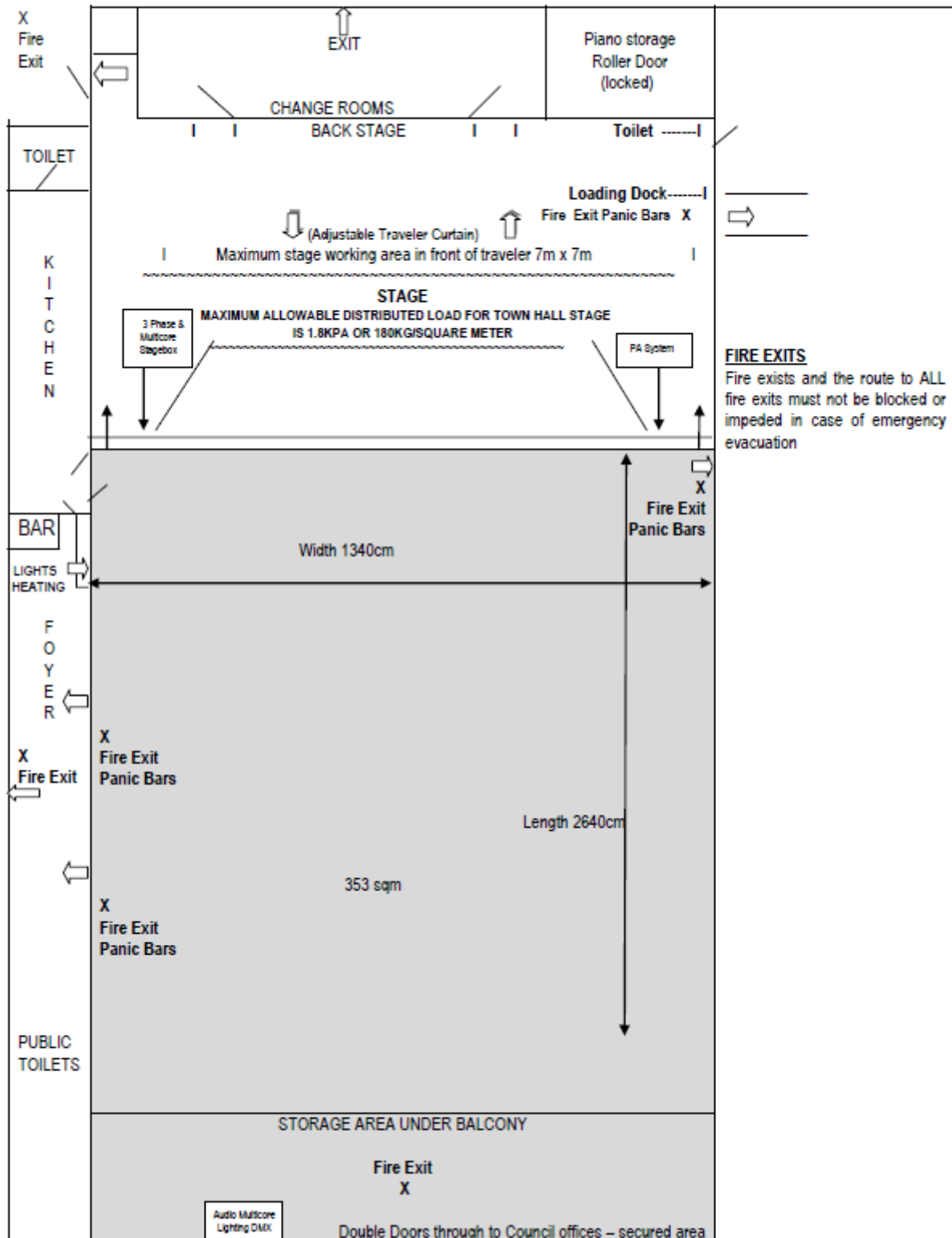

• Civic Centre
• Cnr Lyttleton and Lloyd Sts
• P.O Box 185 Castlemaine VIC 3450
• t (03) 5471 1700
• e info@mountalexander.vic.gov.au
• w www.mountalexander.vic.gov.au